

SoundPoint® IP 650 Quick Start Guide

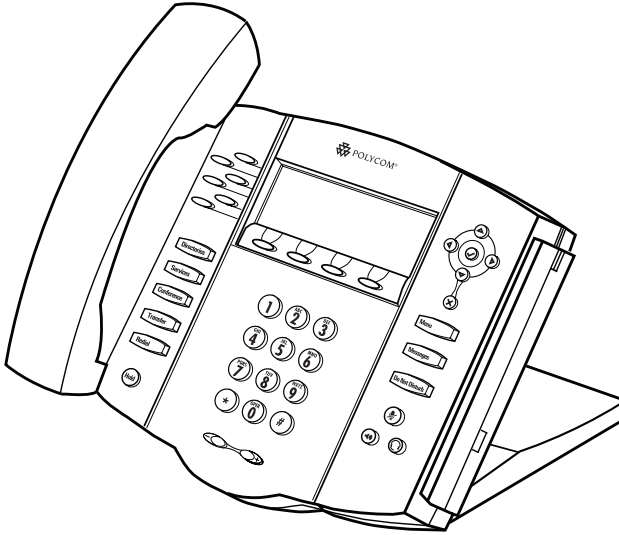

Parts List

Thank you for choosing the SoundPoint® IP 650, a multiple-line Voice over IP telephone with features and functions such as Multiple Call Appearances, Call Hold, Transfer, and Conferencing over an IP network.

These items are included in your SoundPoint IP 650 package. If you are missing any items, contact your SoundPoint IP 650 reseller.

Handset and Handset Cord

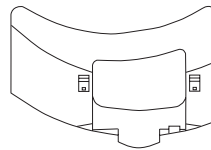
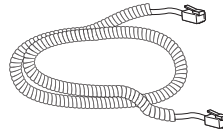

Base Stand

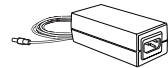

Power Adapter (Not shown: Country-Specific Power Cord)

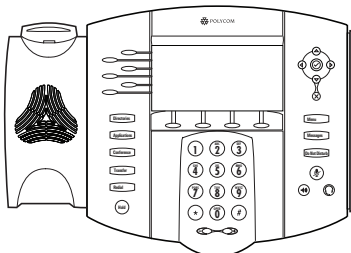

SoundPoint IP 650 Console

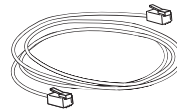

Network Cable



Quick Start Guide

Connect Cables

1. Connect handset and headset, as shown below.

(Note: Headset is an optional accessory, and is not included with this package.)

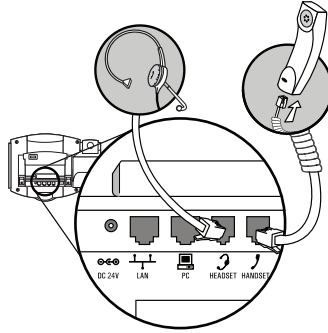

2. Connect network and power, as shown below.

Note: Choose either AC Power Option, or PoE (Power over Ethernet).

AC Power Option

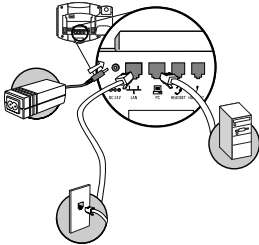

PoE Option

IEEE802.3af compliant
Hub/Switch

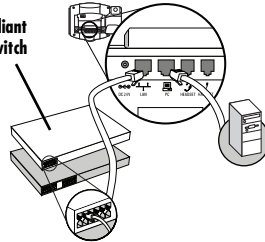

Attach Base Stand

Deskmount Method

Ensure all cables are secured (as shown).

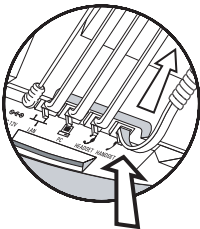

Align base stand tabs with their corresponding insertion points on the phone (as shown).

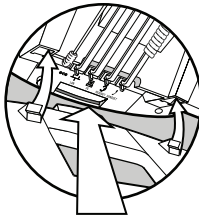

Snap base stand into place (as shown).

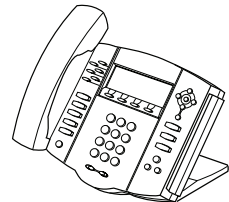

Wallmount Method

Note: Wallmount Unit is an optional accessory, and is not included with this package.

Remove the button from the slot behind the hookswitch, rotate it 180 degrees, and then place it back in the slot (as shown).

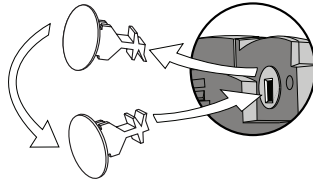

For more information, see "SoundPoint IP Telephone Wallmount Installation" at www.polycom.com/

Using wall anchors, fasten the optional wallmount unit to the wall. Align the base stand tabs with their corresponding insertion points on the phone, and then snap the phone into place (as shown).

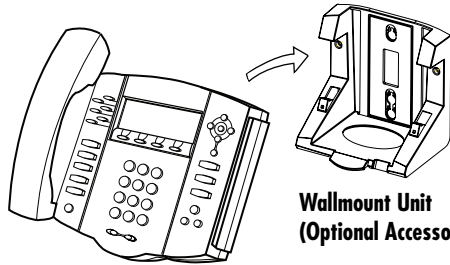

**Wallmount Unit
(Optional Accessory)**

Features

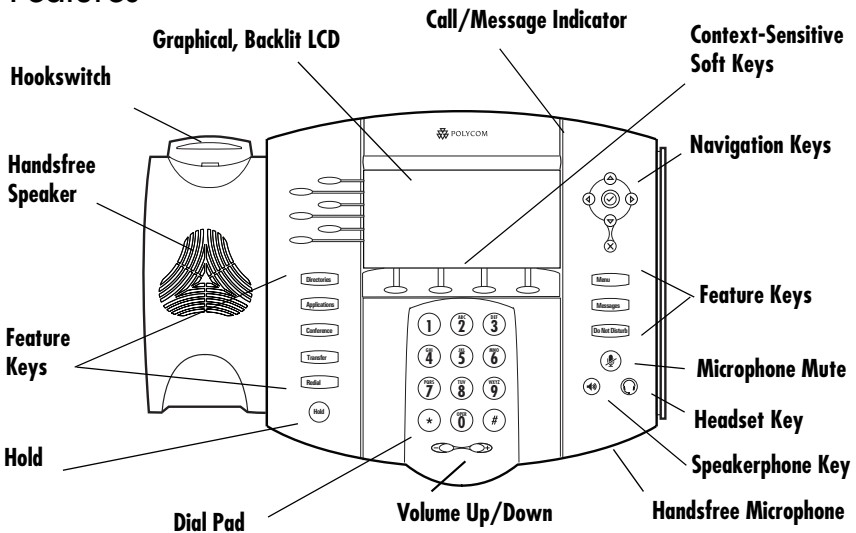

Startup

After it has been connected to the network and supplied with power, the SoundPoint IP 650 automatically begins a process of establishing itself on the network. For more information, see the *SoundPoint IP 650 User Guide*, available online at: www.polycom.com/

